

DATA SHEET

Model N° CKST15.6QL800-0719



Freestanding kiosk with printer

Freestanding Kiosk Dimension and Weight	
Height	1436mm
Depth	456mm
Width	448mm
Weight	45kg
Branding	
Customisable graphics panel	Produced by NMC's in-house graphics team following clients brand guidelines
Height	990mm
Width	420mm
Security	
Drop box	Access doors on both sides of kiosk Double locks to each door and anti-jimmy strips
PC enclosure	2 locks (left and right side)
Finish	
White	Powder coated steel construction
Envelope Size	
C6	114mm x 162mm

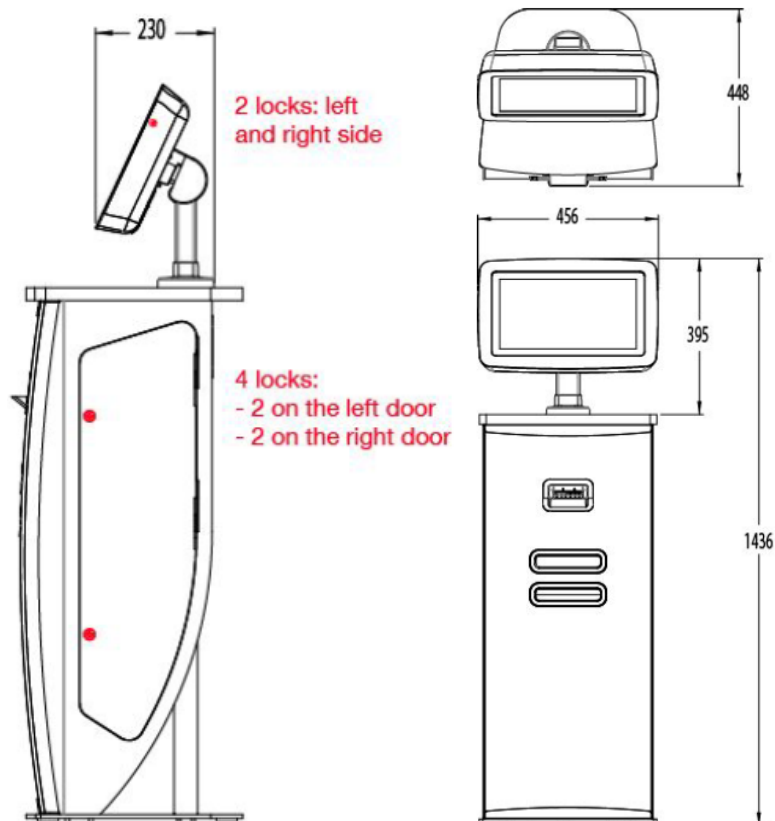

DATA SHEET

Model N° CKST15.6QL800-0719

Setting an Angel on the Iso Pillar Mount

1



Ensure the starting position of the Iso Mount is neutral.

2



To set it at a 90° angle, screw in x2 Set Angle Pegs with x2 M3x6 Caphead Screws, using a 3mm Allen Key into the Iso Mount where '90' is written.

3

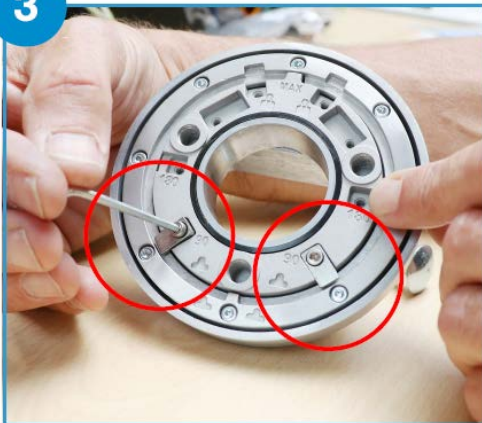

Both Set Angle Pegs are now screwed into the Iso Mount within the 90° section. To change the angle, repeat the process, moving the Set Angle Pegs to a different angle. Different angles can be set for each side. For example, 90° left, 180° right.

4



Now, when rotated, the Iso Mount will lock when it hits your preferred degree. The Iso Mount cannot swivel any further round.

5



You can store the Set Angle Pegs within the blank gaps in the Iso Mount. You can keep them here if you could like the Iso Mount to rotate 360° too.

6

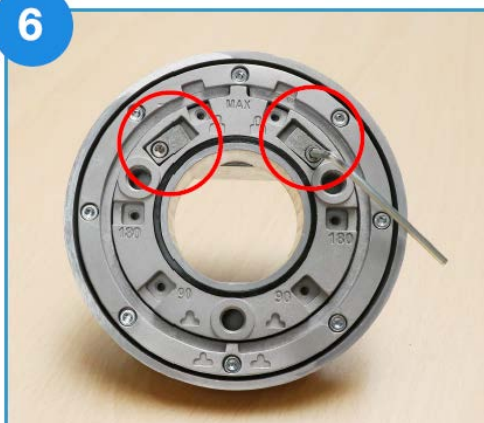

Secure the Set Angle Pegs by screwing in x2 M3x6 Caphead Screws into the Set Angle Pegs and into the Iso Mount.

DATA SHEET

Model N° CKST15.6QL800-0719

15.6 inch Panel PC-0819

Processor	BayTrail J1900 Quad Core
RAM	DDR3 SODIMM 4 GB
SSD	2.5" 128GB (2 slots)
LCD	15.6" (1366 x 768) (WIDE), LED back-lighting Touchscreen Flat, zero bezel multi-touch screen – with projected, capacitive panel (PCAP)
Brightness	250 cd/m ²
Serial	4 serial ports (+ 5/12 V power supply for COM3 / COM4)
USB	5 USB 2.0 ports + 1 USB 3.0 port (for the J1900 version) 4 USB 2.0 + 2 USB 3.0 (for the i5 and i3 version)
LAN	10/100/1000Base-T 2nd Screen Port with support for HDMI, DVI and VGA (mini Display Port)
Audio	Internal loudspeaker, headphones, micro jack plug
Power Supply	+ external 19 V DC
Mini-PCI Express	1 Mini PCI Express slot (WIFI)
EMI	CE/FCC Class A
Safety	LVD, external adaptor UL c/us, CE, TUV, etc.
Operating Temperature	0 ~ 50 °C
Front	Dust- and splash-proof IP 65
Colours	Black Materials Polycarbonate (cover) + aluminium (structure)
VESA	75 x 75
Dimensions (W x D x H)	402.2 x 46 x 251.5 mm
Weight	5 kg
OS	Windows 10 IoT Enterprise, Windows Pro
WIFI / Bluetooth	WIFI 802.11 a/b/g/n + BT 4.0



Brother QL-800

Print	
Printing method	Direct thermal printing
Connectivity	USB
Print resolution	300 dpi
Cutter	Built in cutter
Power supply	Mains
Size	
(W x D x H)	128x213x142 mm
Weight	1.15 kg
System requirements	Microsoft Windows Vista or later Android 4.1 or later
Labels	Brother DK-11201 Standard Address Labels 400 (DK11201 Tape 29mm x 90mm)

DATA SHEET

Model N° CKST15.6QL800-0719

Freestanding Kiosk Installation & Transport

1

Using the enclosure mount tilt the kiosk back to a 35 degree angle.

2

The second person will then carefully lift the base of the integration kiosk from the floor.

Do not lift kiosk from counter top.

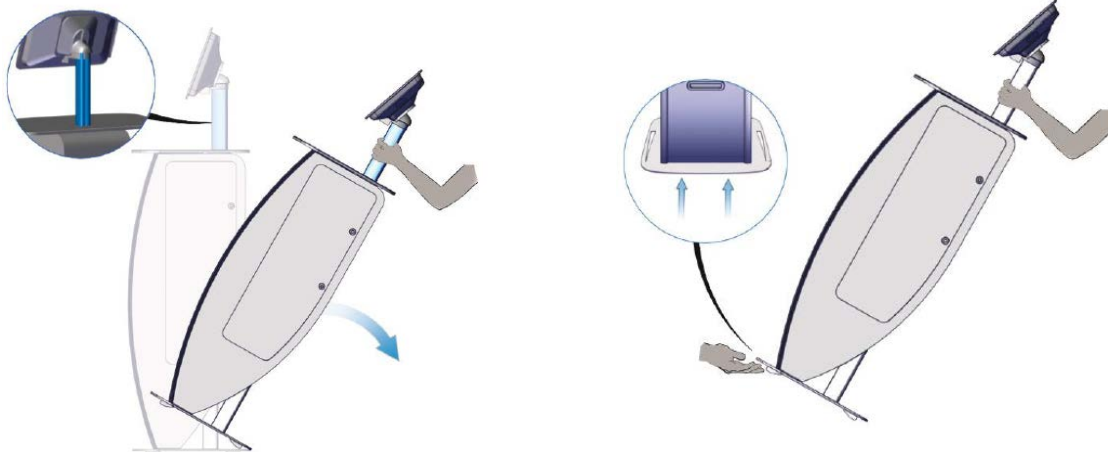

Follow these instructions to ensure warranty is valid.

Surface: The floor upon which the freestanding Self Check-In kiosk stands needs to be level. This is to eliminate the possibility of it toppling over and causing an injury.

Kiosk Safety Tips

TIP Do not put your hand in the kiosk to retrieve keys as it may become trapped!

TIP Do not put hot drinks on the kiosk shelf as a spillage may damage the electrical components!

TIP In our experience you will need to use a box trolley and two people to move the kiosk safely. Before moving the kiosk, please read and become familiar with the manual handling information on the HSE website <http://www.hse.gov.uk/msd/faq-manhand.htm>











DATA SHEET

Model N° CKST15.6QL800-0719

Power supply

Follow the guidelines to avoid fire, electrical shock, or other damage.

■ Power Cord

-  Use only the authorised power source (220—240V AC) for the machine.
-  Use only the power cord included with the machine.
-  Do not handle the power cord or plug if your hands are wet.
-  Do not overload the electrical outlet with too many appliances or plug the power cord into a damaged electrical outlet.
-  Do not cut, damage, alter or place heavy objects on the power cord.
-  Do not use the power cord if it is damaged.
-  Ensure the power cord is correctly inserted onto the electrical outlet.
-  Do not pull the power cord when removing the power plug from the electrical outlet. Doing so could cause an electric shock or fire.
-  Do not bend, break or damage the cord in any way, as this may result in an electrical shock, fire or a machine malfunction.
-  Regularly remove the power plug from the electrical outlet, and clean the base of the pins and between the pins. If you leave the power plug in the electrical outlet for an extended period of time, dust will accumulate at the base of the power plug pins. This could cause a short circuit that may result in a fire.

Keys: Each freestanding Self Check-In Kiosk comes with two separate locks for which we provide two keys each. We recommend you make up two complete sets and keep a master set in a secure location.

Lost or Broken Key? : If you've lost or broken your key, you can order a new set of key's by emailing support@nmcltd.co.uk Please reference the number on the key when ordering.

Cleaning & Maintenance

Top Tip's for Keeping Your Kiosk Looking Brand Spanking New!

For the kiosk - Dust with a clean, damp cloth or chamois, wiping gently. A damp cloth cuts down on friction, helping reduce static electricity, which holds the dust

For the acrylic shelf and stand - This can be washed with a mild detergent and water solution.

For the screen - To clean the screen on the tablet, use a soft, lint-free cloth.

TIP We suggest microfiber cloths. Never use a paper towel or other paper-based towels as they can leave scratches on the screen.

5 year Warranty

Applies to all hardware (kiosk, mounting systems, computer, and printer)

Back to base warranty for all components (customer pays postage to return goods, Nash Management Consultancy pays postage of repaired/replacement parts). Warranty does not include damage sustained through misuse, abuse or accidental damage.

This warranty does not affect your statutory rights.